

ENSURE KIT HAS NOT EXPIRED PRIOR TO USE

INCLUDED WITHIN THE KIT

Inspect the kit to ensure the seal is intact and that all the following components are present

- 1 Single Use Applicator pre-loaded with 1 Dermal Biomarker Patch (DBP)
- Specimen Vial
- 1x Alcohol Pad
- Instructions For Use
- Quick Start Guide
- Specimen Shipper Kit (SSK)
- Instructional Bifold
- Cold Pack
- Specimen Bag With Absorbent
- Test Requisition Form (TRF)



SPECIMEN COLLECTION GUIDE



It is recommended that the patient should not have used topicals for **48 HOURS** or taken biologics **14 DAYS** prior to sampling
Ideally specimens should be returned the **SAME DAY** or stored at 2-8°C until shipping

Specimens **MUST** be returned within 7 days

The cold pack should be frozen for at least **24 hours** before shipping

DO NOT freeze specimen



1 Label The Vial

- Label the Vial with the Patients Initials
- Record the specimen sample ID on the TRF
- (Optional) use peelable sticker on lid to apply to TRF

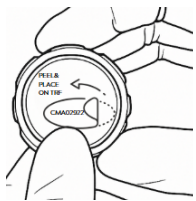

2 Complete TRF

- (Optional) apply specimen vial sticker to TRF
- Complete the remaining required details

3 Collect The Specimen

- Clean the collection area with the alcohol provided and allow to dry
- Remove the peelable seal from the DBP holder in the applicator
- Position the device and patch over the skin area to be sampled
- Once placed on location, move the switch to the unlock position
- Press the device firmly down on the target area, until the patch deploys
- Removed the device and the patch should remain attached to the skin
- Discard the device
- Leave the patch in place for **5 minutes**

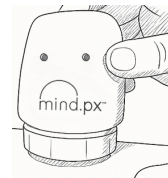

4 Remove DBP

- After the 5 minutes
- Unscrew the cap from the storage vial **BE CAREFUL NOT** to spill contents
- Insert the vial cap into the inner purple part of the collection DBP until you hear a click
- Once secure, use other hand to hold the outer grey ring of the DBP holder
- Lift the vial cap upward leave the grey outer ring attached to the skin
- Screw the vial cap into the vial until sealed
- Remove the remaining holder components from the skin and discard
- If not shipping directly place the specimen **vial at 2-8°C** until packaging

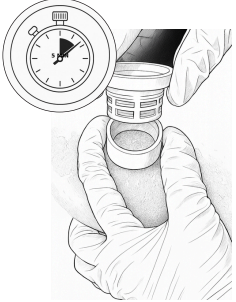

5 Packaging For Shipment

- Take the specimen shipping kit (SSK) and remove the top
- Insert the pre-frozen chill pack inside the polystyrene container
- Take the specimen vial from storage and insert into the specimen bag
- Ensure that the bag is sealed correctly
- Place the specimen vial in bag on top of the chilled box
- Place the lid back on the box
- Assemble the required documents in the envelope provided
- Place envelope on the lid of the box prior to sealing
- Fold the flap and seal with the attached tape
- The specimen is ready for return



6 Ship Specimen

- The return box has a pre-applied FedEx shipping label
- If you have a regular FedEx pick it can be handed over directly
- If you need to schedule a pickup please call Mindera Health at 858-810-6070 option 1



Specimens can be shipped Monday to Friday

Ideally specimen should be returned the **SAME DAY** or stored at 2-8°C until shipping

Specimen **MUST** be returned within 7 days

DO NOT freeze the sample



To Contact Client Relations Please Email Mind.Px@minderahaalth.com or Call 858-810-6070

Mindera Laboratory is a HIPAA-compliant, CLIA-certified, and CAP-accredited laboratory.

(CLIA #05D2189599, CAP #8813410)

minderahaalth.com

1221 Liberty Way, Vista, CA 92081 | Tel: 858-810-6070

© 2025 Mindera Health | ISO 13485:2016 certified